

300x1200 EXPO 100 SYSTEM

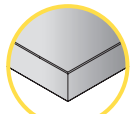

RECTANGULAR STANDARD

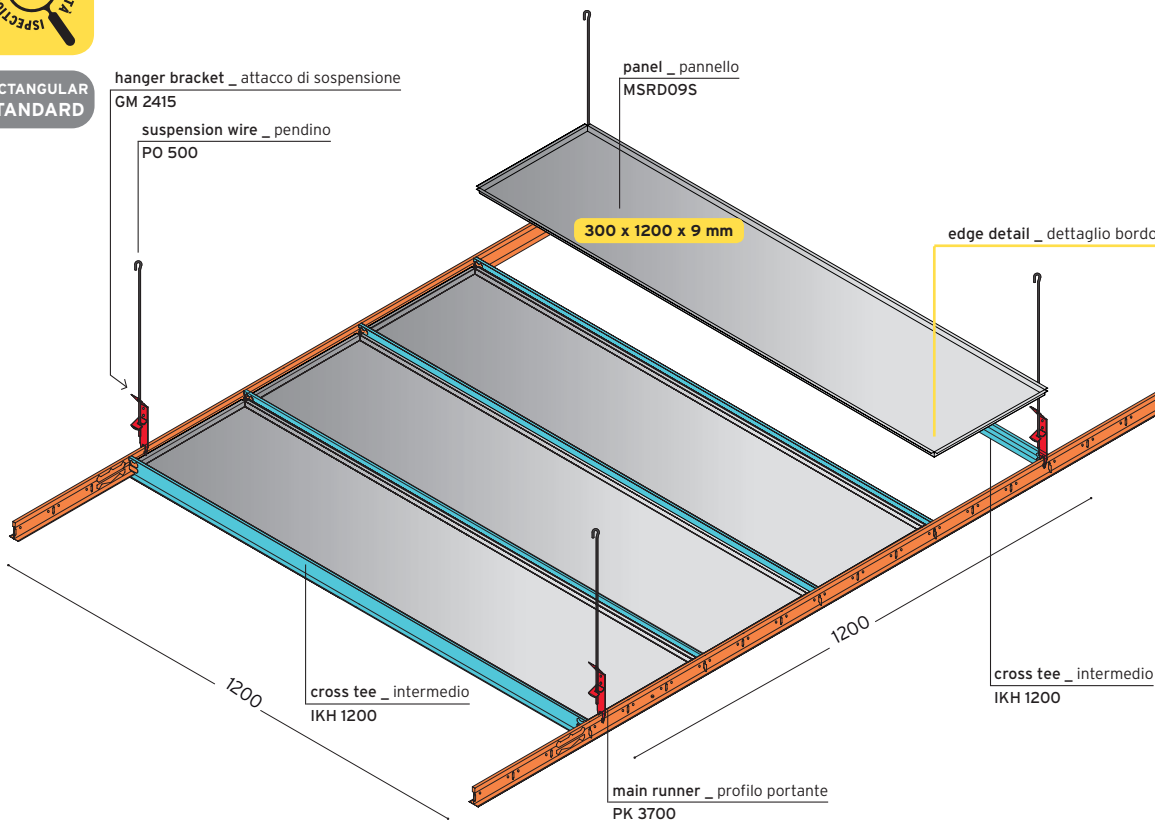

TRIM



REVEAL

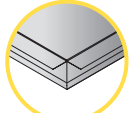

NARROW

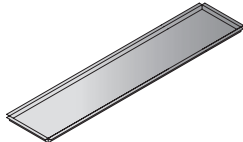

PANEL _ PANNELLO

	thickness _ spessore	finishing _ finiture
 <p>size _ dimensioni 300x1200 mm</p> <p>incidence _ incidenza 2.78 pcs/mq</p>	<p>pre-painted aluminium 0.5/0.6/0.7 alluminio preverniciato 0.5/0.6/0.7</p> <p>pre-painted steel 0.5/0.6 acciaio preverniciato 0.5/0.6</p> <p>post-painted steel 0.5/0.6/0.7 acciaio postverniciato 0.5/0.6/0.7</p>	<p>> cf. perforations / colours / acoustic inlay / perimetral / moldings pages</p> <p>> vedi pagina perforature / colori / prestazioni acustiche / cornici perimetrali</p>

Technical dates / Aspects of performance value _ Dati tecnici / Aspetti pertinenti a valori prestazionali (UNI 13964 - 2005)	
FIRE REACTION _ REAZIONE AL FUOCO A1 (Ex. Class 0) DM 10/03/05 DEC 2000/147/CE	DURABILITY _ DURABILITÀ (membrane _ membrana) protection against corrosion _ protezione contro la corrosione: EN 10327

STRUCTURE _ STRUTTURA

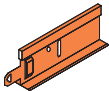
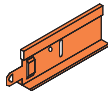
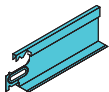
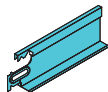
UNICLICK / CLICK / INN / XLINE > cf. catalogue structures and accessories _ vedi catalogo strutture e accessori

REVEAL		NARROW	
PK 3700  main runner _ profilo portante size _ dimensioni incidence _ incidenza 24x38x3700 mm 0.83 ml/mq	PKA 3700  main runner _ profilo portante size _ dimensioni incidence _ incidenza 24x38x3700 mm 0.83 ml/mq		
IKH 1200  cross tee _ profilo intermedio size _ dimensioni incidence _ incidenza 24x38x1200 mm 3.34 ml/mq	IKHA 1200  cross tee _ profilo intermedio size _ dimensioni incidence _ incidenza 24x38x1200 mm 3.34 ml/mq		
GM 2415  hanger bracket _ attacco di sospensione incidence _ incidenza 0.8 pcs/mq	GM 2415  hanger bracket _ attacco di sospensione incidence _ incidenza 0.8 pcs/mq		

Technical dates / Aspects of performance value _ Dati tecnici / Aspetti pertinenti a valori prestazionali (UNI 13964 - 2005)	
FIRE REACTION _ REAZIONE AL FUOCO (Under structure) Class A1 DM 10/03/05 DEC 2000/147/CE	DURABILITY _ DURABILITÀ Protection against corrosion _ Protezione contro la corrosione: EN 10327
MECHANICAL RESISTANCE _ RESISTENZA MECCANICA (Under structure) 95.30 N/m ² Normal break load/Carico normale di rottura-(Under structure) 38.11 N/m ² Normal operating load/Carico normale di esercizio	

member_socio



CBI Europe S.p.A.
Via Mons. A.O. Romero, 14
Località San Biagio
60027 Osimo (AN) _ Italy
tel + 39 071 71 08 688

administration _ amministrazione:
fax +39 071 71 08 635
order _ ordini: fax +39 071 71 08 561
info@cbi-europe.com
www.cbi-europe.com

STRUCTURE_ STRUTTURA

exposed grid system _ struttura a vista con pannello in appoggio

REVEAL

T24

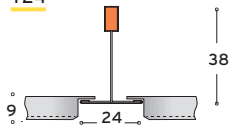

MSRD09S

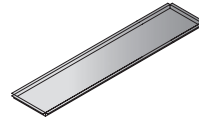

panel reveal edge, 9 mm drop, 3 mm bevel
pannello bordo reveal, ribasso 9 mm, angolo smussato 3 mm



size _ dimensioni
300 x 1200 x 9 mm

incidence _ incidenza
2.78 pcs/mq

NARROW

T15

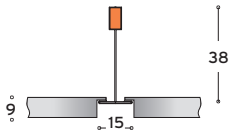

MSND09V

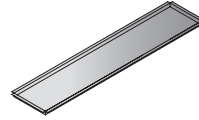

square panel narrow squared edge, 9 mm drop
pannello bordo narrow, angolo vivo, ribasso 9 mm



size _ dimensioni
300 x 1200 x 9 mm

incidence _ incidenza
2.78 pcs/mq

XLINE

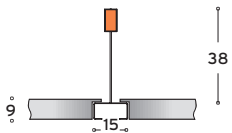

MSND09V

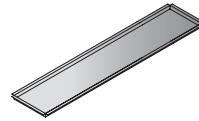

square panel narrow squared edge, 9 mm drop
pannello bordo narrow, angolo vivo, ribasso 9 mm



size _ dimensioni
300 x 1200 x 9 mm

incidence _ incidenza
2.78 pcs/mq