

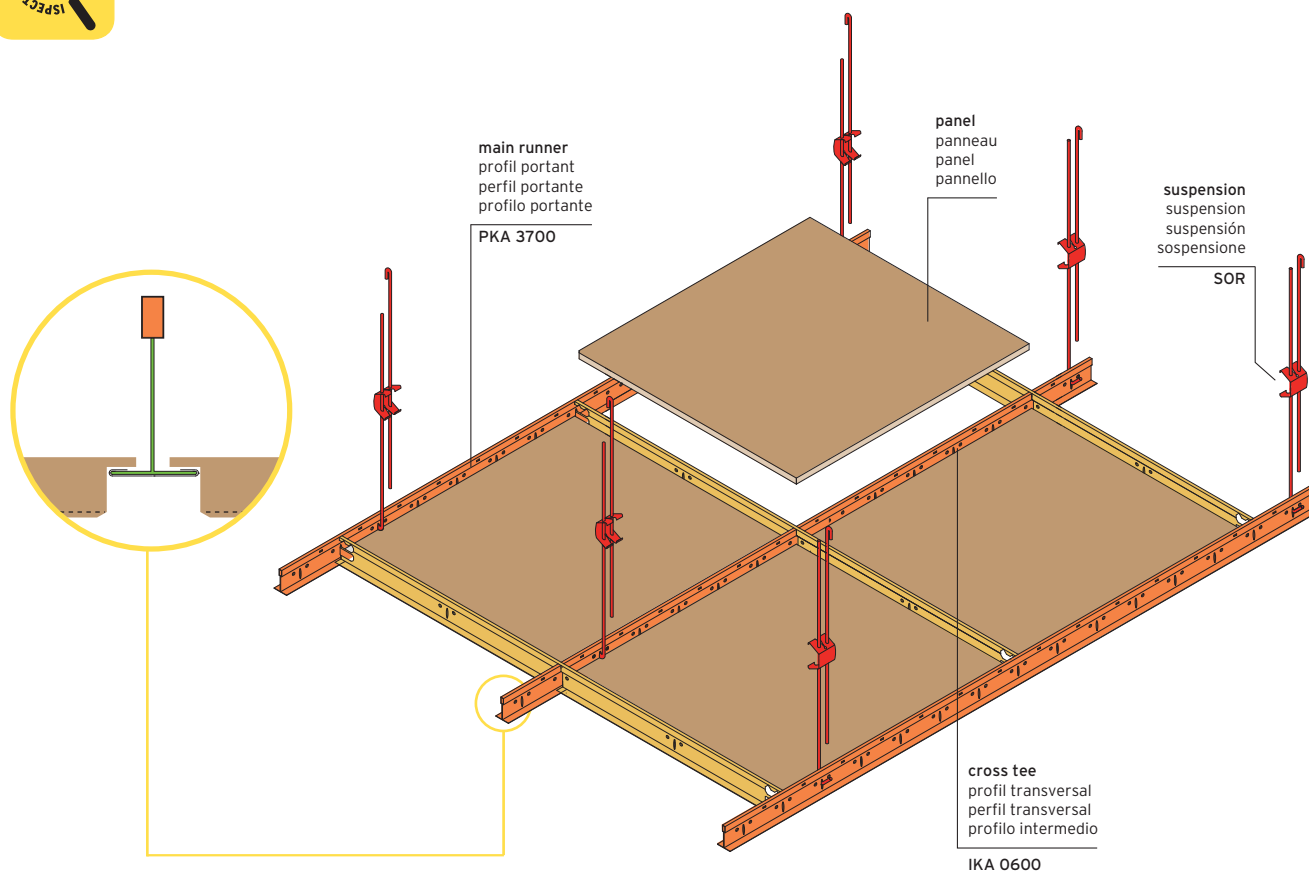

# WOOD EXPO 100 SYSTEM **CWN** NARROW



## PANEL \_ PANNEAU \_ PANEL \_ PANNELLO

SHERWOOD MELAMINE \_ SHERWOOD REAL VENEER \_ ACOUSTIK PLUS \_ SOUND WOOD

CWN

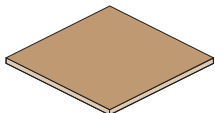

marked down edge panel narrow  
panneau bord surbaissé narrow  
panel borde rebajado narrow  
pannello bordo narrow, angolo ribassato

> cf. perforations/finishing/acoustic inlay pages/accessorizes/modularity  
> cf. perforations/finitions/performances acoustiques/accessoires/modularité  
> cf. perforaciones/acabados/rendimiento acustico/accesorios/modularidad  
> cf. perforature/ finiture/prestazioni acustiche/accessori/modularità

## STRUCTURE \_ STRUCTURE \_ ESTRUCTURA \_ STRUTTURA

system detail \_ details du système \_ detalles de sistema \_ dettaglio sistema

system components \_ éléments du système \_ elementos de sistema  
elementi del sistema

T15

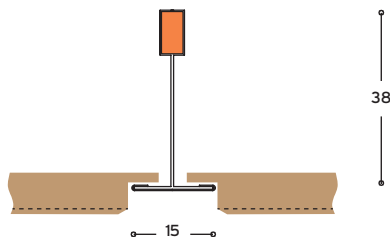

exposed grid \_ structure visible \_ estructura visible \_ struttura a vista

Technical dates / Aspects of performance value (UNI 13964 - 2005)  
Dati tecnici / Aspetti pertinenti a valori prestazionali (UNI 13964 - 2005)

FIRE REACTION \_ REAZIONE AL FUOCO  
(Under structure) Class A1 DM 10/03/05 DEC. 2000/147/CE

MECHANICAL RESISTANCE \_ RESISTENZA MECCANICA  
(Under structure) 269.5 N/m<sup>2</sup> Normal break load/Carico normale di rottura  
(Under structure) 107.8 N/m<sup>2</sup> Normal operating load/Carico normale di esercizio

DURABILITY \_ DURABILITÀ  
Protection against corrosion \_ Protezione contro la corrosione: EN 10327

PKA 3700

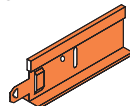

main runner \_ profil portant  
profil portante \_ profilo portante

size \_ dimensioni incidence \_ incidenza  
24x38x3700 mm 1.67 ml/mq

IKA 0600

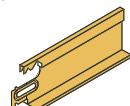

cross tee \_ profil transversal  
profil transversal \_ profilo intermedio

size \_ dimensioni incidence \_ incidenza  
24x38x600 mm 1.67 ml/mq

SOR



suspension \_ suspension  
suspensión \_ sospensione

incidence \_ incidenza  
4 pcs/mq